



St. Philips Grove Clifton, York YO30 6JT

£275,000



Located in the ever-popular residential area of Clifton and set on a generous plot, this beautifully renovated townhouse is ready for its next owners to move straight in. Offered with no onward chain, it presents an ideal opportunity for first-time buyers or those looking for a stylish and low-maintenance home. With a range of local amenities close by, as well as York city centre and the train station within comfortable walking distance, the location could not be more convenient.

Inside, the welcoming entrance hall leads through to a bright and airy reception room, where a large front window allows natural light to pour through. To the rear sits the impressive open-plan kitchen diner, fitted with elegant shaker-style wall and base units providing excellent storage and generous worktop space, complemented by contemporary metro-tiled splashbacks. The room offers ample space for both dining and relaxation, with plenty of room for freestanding appliances to suit modern lifestyles.

To the first floor are three well-proportioned bedrooms, served by a stylish and well-presented three-piece family bathroom.

Externally, the property benefits from ample driveway parking to the front, while to the rear lies a generous south-facing garden offering excellent potential for extension, subject to the relevant planning permissions. The garden is predominantly laid to lawn, with defined seating areas and fenced boundaries providing both privacy and space to enjoy outdoor living. A brick-built outstore offers useful additional storage.

Offered with no onward chain, this wonderful home is sure to appeal to a range of buyers, and early viewing is highly recommended.

Council Tax Band B





St. Philips Grove Clifton, York YO30 6JT

Freehold
Council Tax Band - B

- Townhouse
- Three Bedrooms
- Driveway Parking
- Generous Garden
- South Facing Rear Garden
- Popular Residential Area
- No Onward Chain
- EPC E

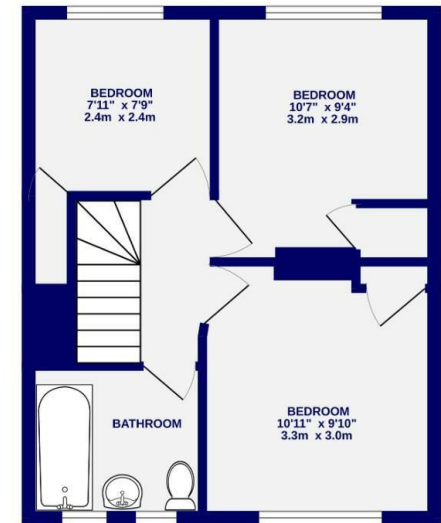
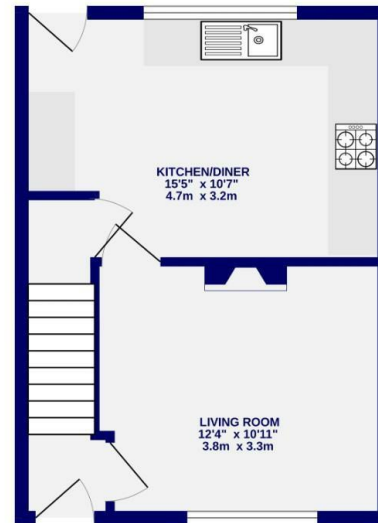

TOTAL FLOOR AREA : 703 sq.ft. (65.3 sq.m.) approx.
Whilst every attempt has been made to ensure the accuracy of the floorplan, measurements of rooms and any other items are approximate. If included in the plan the garage/shed will form part of the overall floor area and no responsibility is taken for any error, omission or mis-statement. This plan is for illustrative purposes only and should be used as such by any prospective purchaser. The services, systems and appliances shown have not been tested and no guarantee as to their operability.
Made with Metropix ©2025

These particulars have been prepared as accurately and as reliably as possible, but should not be relied upon as 'statement of fact'. If there is any point which is of particular importance to you, please contact the office and we would be pleased to check the information. We have not tested any services, appliances, equipment or facilities and nothing in these particulars should be deemed to be a statement that they are in good working order, or that the property is in good structural condition or otherwise. Any areas, measurements, floor plans or distances referred to are given as a guide only and are not precise. Purchasers must satisfy themselves by inspection or by otherwise regarding the items mentioned above and as to the correctness of each of the statements contained in these particulars. No person in the employment of Ashtons has any authority to make or give any representation or warranty whatsoever in relation to this property or these particulars nor enter into any contract relating to the property on behalf of the vendor.